

PLX-PURE LEAD HIGH RATE

PLX12-420 (12V420W)

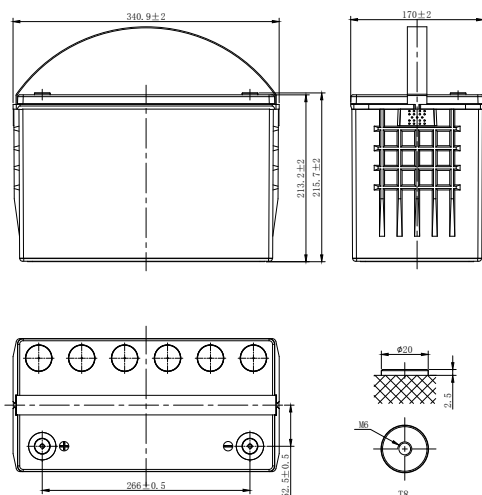

CHARACTERISTICS

Item	Specifications	
Rated Voltage	12V	
Nominal Rate (25°C)	$W_{15}, 1.67V/cell$	420W/cell
Nominal Capacity (25°C)	$C_{10}, 1.80V/cell$	100Ah
Dimension	Length	340.9mm (13.4inches)
	Width	170mm (6.69inches)
	Container Height	213.2mm (8.39inches)
	Total Height	215.7mm (8.49inches)
Approx Weight	33.5kg (73.9lbs)	
Terminal	T8(M6)	
Container Material	PC-ABS (UL94 V-0)	
Short-circuit current	2200A	
Internal Resistance (25°C)	Approx 3.5 mΩ (Fully charged)	
Operating Temp. Range	Discharge	-40~65°C (-40~149°F)
	Charge	-20~54°C (-4~129°F)
	Storage	-20~50°C (-4~122°F)
Nominal Operating Temp. Range	25±3°C (77±5°F)	
Max.Charging Current (25°C)	0.3C	
Charge voltage (25°C)	Standby Use	Equalization Use
	2.27±0.02V/cell	2.35-2.40V/cell
Temp. Coefficient	-3mV/cell/°C	-4mV/cell/°C
	40°C (104°F)	103%
Effect of temp. to Capacity	25°C (77°F)	100%
	0°C (32°F)	86%
	Self Discharge	PLX series batteries can be stored up to 24 months at 25°C(77°F), For higher temperatures the time interval will be shorter.Battery needs to be given a freshening charge when the OCV approach 2.10V/cell or when the maximum storage time is reached, whichever occurs first.

DISCHARGE TABLE

Constant Current Discharge (Amperes) at 25°C (77°F)															
F.V/Time	5min	10min	15min	20min	30min	45min	1h	1.5h	2h	3h	4h	5h	8h	10h	20h
1.85V/cell	288.7	214.5	169.8	153.0	111.6	84.4	67.1	47.6	37.8	27.1	21.7	17.6	11.9	9.80	5.10
1.80V/cell	332.4	247.3	189.2	167.2	119.3	88.7	69.8	49.7	39.6	28.3	22.6	18.4	12.3	10.0	5.20
1.75V/cell	363.4	270.7	205.0	178.4	126.9	91.2	71.8	51.1	40.7	29.0	23.2	18.8	12.5	10.1	5.26
1.70V/cell	391.5	292.7	218.1	187.7	131.8	94.5	74.6	52.4	41.3	29.6	23.6	19.1	12.6	10.3	5.31
1.67V/cell	437.0	308.3	230.1	194.9	137.1	98.2	76.2	53.5	42.1	29.9	23.9	19.3	12.8	10.3	5.35
1.60V/cell	472.3	313.5	237.8	200.4	139.8	99.7	77.5	54.3	42.7	30.3	24.2	19.5	12.9	10.4	5.39

Constant Power Discharge (Watts/cell) at 25°C (77°F)															
F.V/Time	5min	10min	15min	20min	30min	45min	1h	1.5h	2h	3h	4h	5h	8h	10h	20h
1.85V/cell	573.6	419.4	334.0	302.6	221.8	168.5	134.3	95.5	76.1	54.7	44.1	35.8	24.4	20.1	10.6
1.80V/cell	649.0	478.8	368.6	327.5	235.1	175.7	138.9	99.0	79.1	56.7	45.6	37.3	25.1	20.5	10.7
1.75V/cell	696.7	519.2	395.8	346.3	247.9	179.1	141.7	101.1	80.8	57.8	46.6	37.9	25.4	20.6	10.8
1.70V/cell	756.7	550.0	418.0	360.4	254.7	183.8	146.0	102.9	81.4	58.6	47.0	38.2	25.5	20.8	10.8
1.67V/cell	815.0	570.0	420.0	372.1	263.6	189.8	148.4	104.4	82.4	58.9	47.4	38.3	25.7	20.8	10.8
1.60V/cell	857.9	575.0	443.0	378.8	266.0	191.1	149.6	105.1	82.9	59.1	47.5	38.3	25.7	20.9	10.9

PLX-PURE LEAD HIGH RATE

PLX12-420 (12V420W)



APPLICATIONS

- UPS
- Emergency lighting
- Emergency Power supply
- Electric starting
- Power tools

GENERAL FEATURES

- 15 years design life (25°C)
- Utilizes TPPL technology, thin positive grids and unique manufacturing process to maximize corrosion resistance and service life while increasing energy density
- Specifically designed for high-rate discharge applications
- Wide Wpc range of front and top terminal monoblocs
- UL 94 V-0 Case and cover heat sealed and 100% tested to prevent leaks

STANDARDS

- Compliance with IEC 60896 standards
- Classified as "Very Long Life" according to Eurobat
- CE,UL Approved
- Manufactured in Leoch@IATF 16949, ISO 45001,ISO 9001 and ISO 14001 certified production facilities

Discharge Characteristics

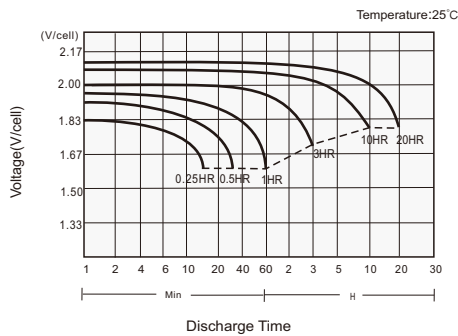

Charging Characteristics

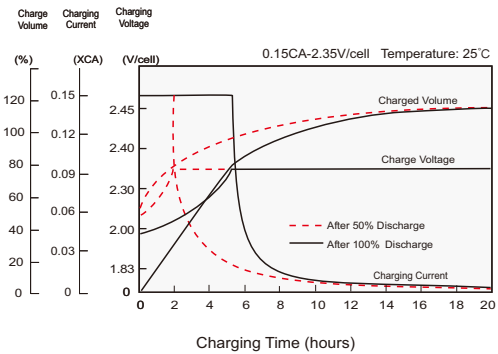

Effects of Temperature on Capacity

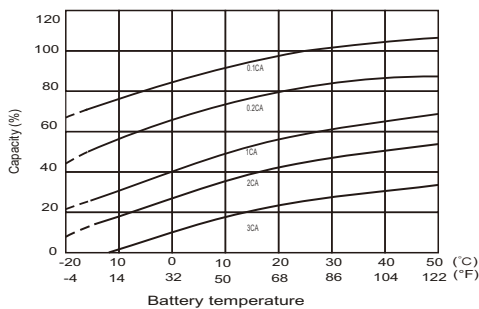

Self Discharge Characteristics

