

Datenblatt – G07 06 245

Blockbatterie, wartungsfrei

Performance

Nennspannung:	6 V
Nennkapazität C5:	245 Ah
Nennkapazität C20:	280 Ah
Zyklusfestigkeit:	700 Zyklen bei 70% DOD
Legierung:	Ca/Ca
Elektrolyt:	GEL
Gasableitung:	VRLA
Separator:	Mikroporöser Blattseparator
Batteriegewicht (+/- 5 %):	45 kg
Ladeprofil IU:	I = min. 12% C ₅ max. 18% C ₅ U = 2.4 V pro Zelle
Ladeprofil IUI:	I1 = min. 12% C ₅ max. 18% C ₅ U = 2.35 V pro Zelle I2 = 1.5 % C ₅ für max. 4 Stunden

Abmessungen und Gewichte

Gehäuse:	BCI305
Länge:	302 mm
Breite:	178 mm
Höhe:	366 mm
Polausführung:	DUAL

Normen

Stoffnummer:	UN 2800 Sonderbestimmung ADR 598
DIN/E Normen:	IEC 61056, IEC 61427, IEC 60896

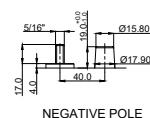
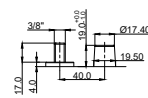
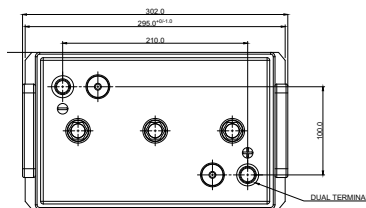
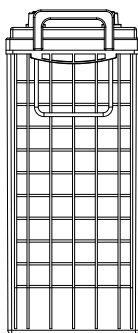
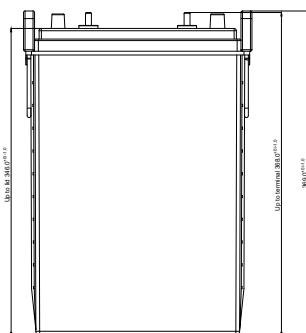

Data sheet – G07 06 245

Block battery, maintenance-free

Performance

Nominal voltage:	6 V
Nominal capacity C5:	245 Ah
Nominal capacity C20:	280 Ah
Cycle life:	700 cycles at 70% DOD
Alloy:	Ca/Ca
Electrolyte:	GEL
Gas discharge:	VRLA
Separator:	Microporous leaf separator
Battery weight (+/- 5 %):	45 kg
Charge profile IU:	I = min. 12% C ₅ max. 18% C ₅ U = 2.4 V per cell
Charge profile IUI:	I1 = min. 12% C ₅ max. 18% C ₅ U = 2.35 V per cell I2 = 1.5 % C ₅ for max. 4 hours

Dimensions and Weights

Housing:	BCI305
Length:	302 mm
Width:	178 mm
Height:	366 mm
Pole version:	DUAL

Standards

Substance number:	UN 2800 Special provision ADR 598
DIN/E Standards:	IEC 61056, IEC 61427, IEC 60896

